

Start With the Selection Process

Before sampling you must choose plants from the plot you are wanting to test. Follow the guidelines below for picking the most optimal plants.

1. Select 10 female plants from a single orchard, but from vines spread across the block. Choose plants from the same variety, age, and similar management history.
2. Select upward facing axillary buds, excluding the most distal bud. The goal is to provide a group of buds with similar budbreak characteristics.
3. Using a sharp knife or clippers, cut 25 buds total off the 10 female plants selected. When removing the bud, make sure to remove it entirely. Including the portion of bud tissue that can protrude into the cane.

These 25 buds will be used to create the testing sample and should be used within 5 minutes after cutting from the plant.

After Selecting Your Bud Samples

This booklet will guide you through the Hazel Trex™ sampling process. Simply follow the steps inside:

- A** Making the Juice Sample
- B** Placing the Juice Sample on the Card
- C** Sending the Sample

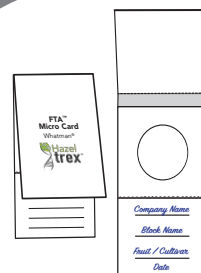

Open the Micro Card found inside the Hazel Trex™ box. Write your Company Name, Block Name, Date, Fruit Type & Cultivar on the bottom portion.



hazel technologies, inc.

Have Questions? Contact Our Team!

Hazel Trex Test Support:
support@hazeltechnologies.com
+1 (559) 321-2146

Hazel Trex Sample Registration
dashboard.hazeltechnologies.com

General Questions:
www.hazeltechnologies.com



Before You Begin Sampling

The following information is required for successful registration and accurate test results.

Please register your sample online before starting the sampling process.

Crop	Field / Lot of Origin
Variety	Number of Vines Sampled
Sample Date	Number of Buds Sampled
Sample Time	Intended Budbreak Agent

To Register, Please Visit:
dashboard.hazeltechnologies.com

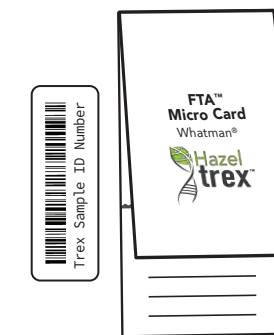

The Sample ID Number can be found on the back of the Micro Card.

A

Making the Juice Sample

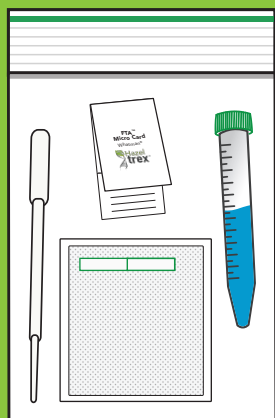

What You'll Need

- 25 Buds
- Extraction Bag
- Falcon Tube with Buffer Solution
- Pipette
- Hammer

1

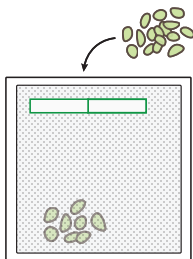

Place the 25 buds selected from female plants into the extraction bag.

2

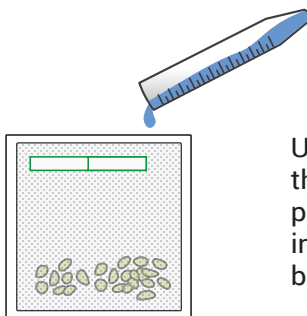

Unscrew the cap of the falcon tube and pour buffer solution into the extraction bag filled with buds.

3

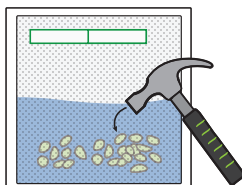

Close and hold the bag shut with your hands. Smash the outside of the bag gently, using a hammer to avoid splitting the bag, until buds and fluid form a fine consistency. (No more than 1 Minute)

4

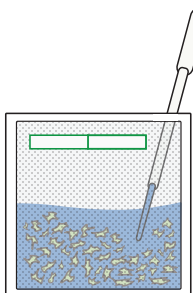

Use the pipette to evenly stir the mixture. Extract two large drops from the bag using the pipette.

B

Placing the Juice Sample on the Card

This section of the Hazel Trex™ sampling process is the most critical for ensuring accurate test results. Please read the instructions carefully before attempting to place the juice sample on the card.

1

Squeeze the liquid from the pipette into two large circles on the Micro Card.

Make sure both drops of fluid are inside of the marked circle on the card.

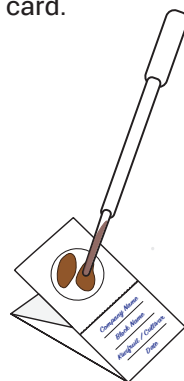

X

Insufficient Color



✓

Optimal Color



2

Place the Micro Card aside for a minimum of 2 Hours to let the sample fluid air dry away from direct sunlight.

Do not close the Micro Card while air drying.

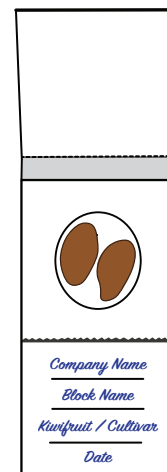

3

Once the sample fluid is completely dry, close the Micro Card and place it into the small bag containing the desiccant.

Make sure the bag is sealed.



C

Sending the Sample



DON'T FORGET TO REGISTER YOUR SAMPLE
www.dashboard.hazeltechnologies.com

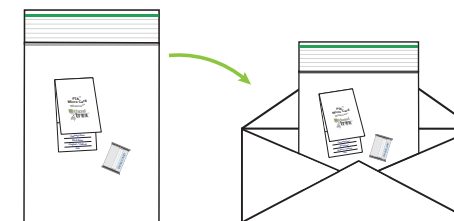

Place the small bag containing the card and desiccant into the pre-labeled courier bag found in your Hazel Trex™ box.

Seal the envelope and mail.

Eurofins BioDiagnostics, Inc.

Attn: Asgar Shir
1821 Vista View Dr.
Longmont, CO 80504

Telephone: +1(720) 745-6378

Test results will be communicated by email within 2 business days.